



COAX CO., LTD.

SMA plug connector assembly instructions

Specification No.	Connector	Cable type
SH981028-01	AX-358P , AX-358P-NM	SC-358/50 series

Supplied parts

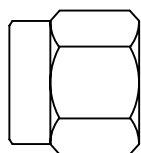

Coupling nut



Gasket



Retaining ring

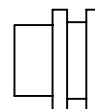

Housing

1. Cut cable
Cut cable end needs to be plain.
2. Soldering housing
 - (1) Insert housing on the cable and fix it at 2.5mm from cable end as diagram.
 - (2) Solder cable and housing at fixed position.
Try to solder in a short time.
 - (3) Check at part A & B, uniformly soldered.
3. Clean rosin flux
4. Strip cable
 - (1) Strip center conductor.
Stripped cable end needs to be plain.
5. Trim center conductor
 - (1) Trim stripped cable at lengths of 2.0~2.5mm and angle 70° ~ 90° by using file.

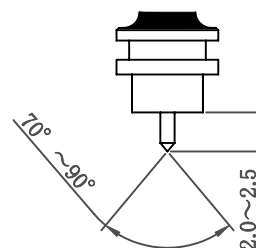
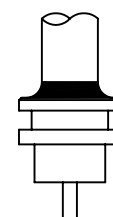
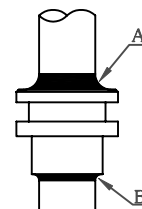
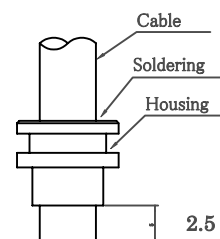
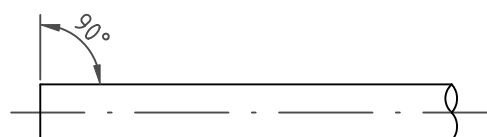

* Please try to solder in a short time.

Date	Drawn	Checked	Approved
'98. 10. 28	Kasai	Seino	Kasai

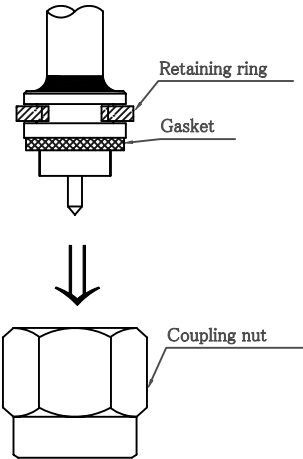
Specification No.	Connector	Cable type
SH981028-01	AX-358P , AX-358P-NM	SC-358/50 series
<div>6. Assembling coupling nut</div> <div>(1) Insert gasket.</div> <div>(2) Attach retaining ring.</div> <div>(3) Squeeze retaining ring to the diameter of coupling nut and assemble coupling nut with the housing.</div> <div>Check if the coupling nut rotate smoothly after assembling.</div>		 <p>The diagram illustrates the assembly process for the coupling nut. The top part shows a cross-section of a cable with a retaining ring and a gasket being inserted. The bottom part shows the completed assembly with the coupling nut attached to the housing.</p>

* Please try to solder in a short time.